

Energy Meter 250 A Kit

External meter for dynamic load management with cable type current transformers

The Energy Meter 250 A Kit can be used to set up dynamic load management for the Supernova DC fast chargers and the Wallbox ABL Pulsar AC charging stations, which ensures maximum charging power taking into account the upper current limit, while also protecting the house connection from overload. In addition, the external meter enables the efficient integration of a PV system and ensures an optimum ratio of solar power and grid power for the charging process via the solar charging mode. With direct measurements, the energy meter, which is designed as a top-hat rail module, can measure currents up to 65 A, while measurements up to 250 A are possible in connection with the cable type current transformers. The Energy Meter 250 A Kit is easily put into operation using the Wallbox app, and then allows visual monitoring of the charging current and the building load. If required, the Energy Meter 250 A Kit can be combined with the Wallbox ABL Pulsar Dienstwagen Bundle.



Product number 100000679

General information

Model	Energy Meter 250 A Kit
Manufacturer number	MTR-3P-250A-CLP
Product number	100000679
EAN number	8436575274997
Commodity code	90318080
Packaging dimensions (H×W×L)	280 × 70 × 105 mm
Weight (gross)	Approx. 1 kg
Packaging unit (PU)	1 unit
Items supplied	Energy meter, 3 cable type current transformers up to 250 A, download information

Mains power supply

Connection cross section in line with EN 60204	Up to 16 mm ²
Tightening torque for current terminals	2.8 Nm
Starting current	20 mA
Power supply	208 ~ 400 V AC, VLL ± 20 %
Frequency	45 / 60 Hz
Internal consumption P _{max}	≤ 1 W

Revision status ABL_WBX_10000679_EN_a,12/24

ABL GmbH · Albert-Büttner-Straße 11 · D-91207 Lauf / Pegnitz · Tel. +49 (0) 9123 188-0 · info@abl.de · www.abl.de · www.ablmobility.de

Wall Box Chargers S.L.U. · Carrer del Foc, 68 · 08038 Barcelona · Spain · www.wallbox.com

Page 1 of 3

Measuring circuit for measuring category III

Limit current I_N / phase	250 A
Rated voltage	400 V AC, VLL \pm 20 %
Frequency	50 / 60 Hz

Measured values and measurement accuracy

Voltage	\pm 0.5 %*
Current	\pm 0.5 %*
Active power	\pm 1.0 %*
Reactive power	\pm 2.0 %*
Power factor	\pm 1.0 %*
Active energy	Class 1
Reactive energy	Class 2

Operating conditions

Ambient temperature during transportation / storage	-30 to 80°C
Operating temperature	-25 to 65°C
Relative humidity	0 to 90 %
Class of protection	III

Housing

Type	Top hat rail module
Fixing type	TH35 top hat rail
Housing material	Noryl, self-extinguishing: UL 94 V-0
Housing colour	White
IP rating	IP51 (front), IP20 (screw terminals)
Interfaces	1 \times RS485
Net dimensions (H \times W \times D)	90 \times 54 \times 63 mm
Weight (net)	0.24 kg

Compatibility

Energy management platform	Sirius Controller (Kit A)
DC charging systems	Supernova (all variants)
AC charging systems	Wallbox ABL Pulsar (all variants)

Cable type current converter specifications

IP rating	IP20
Ambient temperature (operation)	-20 to 65°C
Ambient temperature (storage)	-25 to 80°C
dimensions	65.5 × 46 × 35 mm
Secondary output	UL R/C cable, 16 AWG (1.3 mm ²)
Cable diameter	24 mm
Cable length	0.5 m
Primary/secondary power	300 A / 5 A
Frequency	50 / 60 Hz
Nominal insulation level	0.72 kV ac, dielectric strength 3 kV ac for 1 minute
Insulation class	Thermal class B (IEC 60085)
Accuracy (EN61869-2)	Class 1
Burden	2.5 VA

Dimensioned drawing

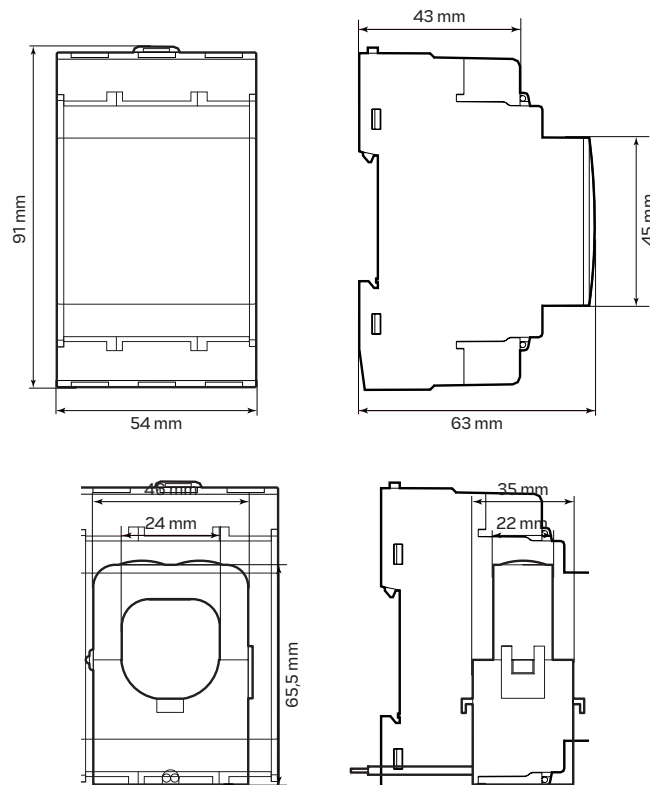

Subject to change: All performance characteristics, technical and other specifications are subject to change without prior notice.

Revision status ABL_WBX_10000679_EN_a,12/24

ABL GmbH · Albert-Büttner-Straße 11 · D-91207 Lauf / Pegnitz · Tel. +49 (0) 9123 188-0 · info@abl.de · www.abl.de · www.ablmobility.de

Wall Box Chargers S.L.U. · Carrer del Foc, 68 · 08038 Barcelona · Spain · www.wallbox.com